

# CHO49, CHO50

## Product introduction

Low-frequency rectangular electrical connectors CHO49 (single) and CHO50 (duplex) work in the circuit of DC and AC pulse current. This series of electrical connector plugs and sockets is an embedded connection. The insulator in the metal shell of the plug seat is not equipped with a contact body. When in use, use a pick-up tool to send the contact body into the hole of the insulator. The contact body is a crimping type, which is an improved remote control of PPKM1-4. It can be interchanged with CHO49, CHO50 series electrical connectors and docking remote.

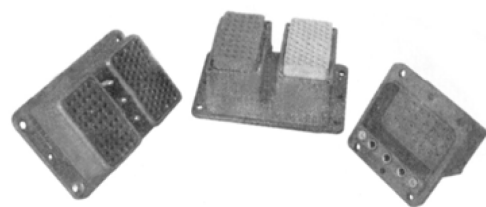

## Technical performance

Ambient temperature:  $-60^{\circ}\text{C} \sim +155^{\circ}\text{C}$   
 Vibration (sinusoidal):  $1 \sim 5000\text{Hz}$   $140 \text{ s/m}^2$   
 Shock acceleration:  $-\text{once } 5000 \text{ m/s}^2, \text{ repeatedly, } 1500 \text{ m/s}^2$   
 Operating voltage: 400V, 700V  
 Single contact working current: 11A, 20A  
 Contact resistance:  $\emptyset 1.0 \leq 5\text{m}\Omega, \emptyset 1.5 \leq 2.5\text{m}\Omega$   
 Insulation resistance:  $\geq 5000\text{M}\Omega$   
 Working life: plugging 500 times, 1000 hours  
 Shelf life: 15 years  
 Technical conditions: GEO.364.246TY

## Mark description

	<b>CHO49 (50)</b>	<b>- 26 (38,45,57,67)</b>	<b>/ 43x34 (60x43)</b>	<b>B (P)</b>	<b>- 6 (7)</b>	<b>- a (b)</b>	<b>- B</b>
Model	CHO49 Single CHO50 Duplex						
Number of contacts							
	CHO49: Plug 44x36, Socket 43x34. CHO50: Plug 63x44, Socket 60x43						
	B – plug part (pins) P – socket part (holes)						
Structure type:	6 – no tail attachment 7 – tail attachment						
Combination form of contact body:	a – combination of 26 and 57 holes b – combination of 45 and 38 holes						
All-weather							

**CHO49, CHO50 Composite environment-resistant crimping rectangular electrical connector**

Example:

Russian	Chinese
CHO49-26/44x36B-6-B CHO50-83/60x43B-65-B	CHO49-26/44x36B-6-B CHO50-83/60x43B-6-b-B

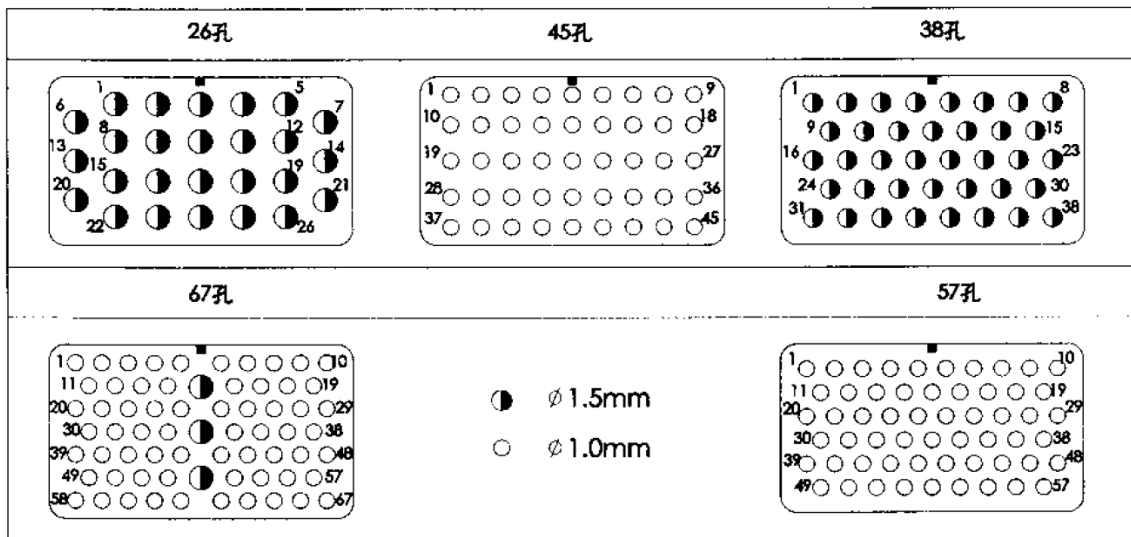
**Insulator Hole Arrangement**

**Connector shape and installation dimensions**
**CHO49**

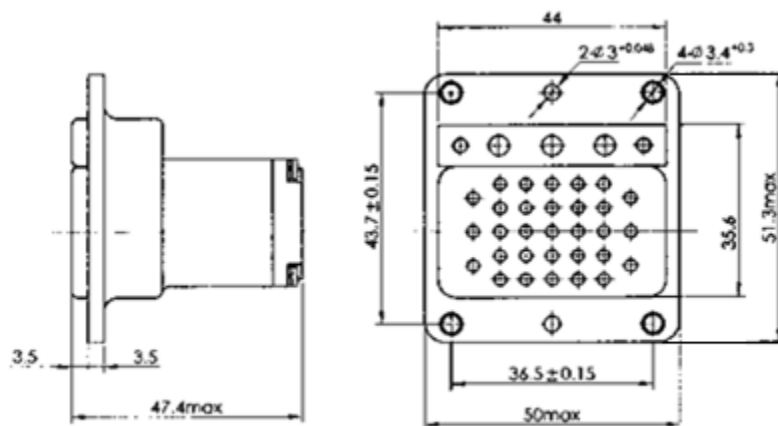
- Plug



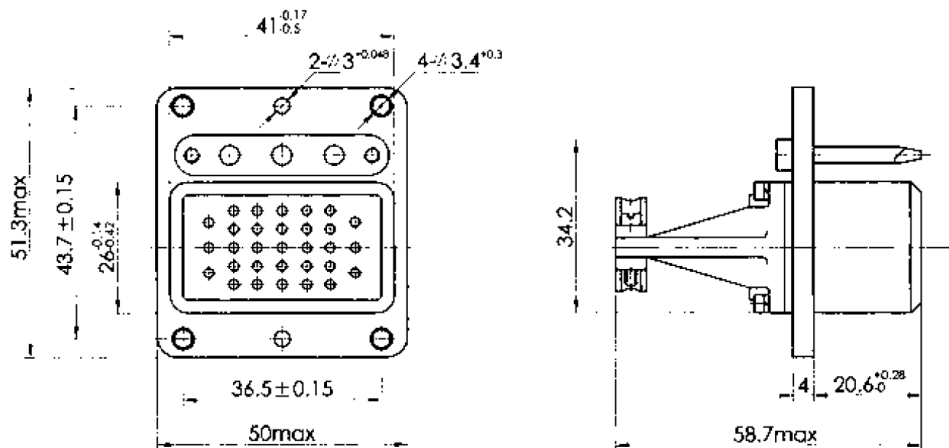

- Socket



### CH050

- Plug

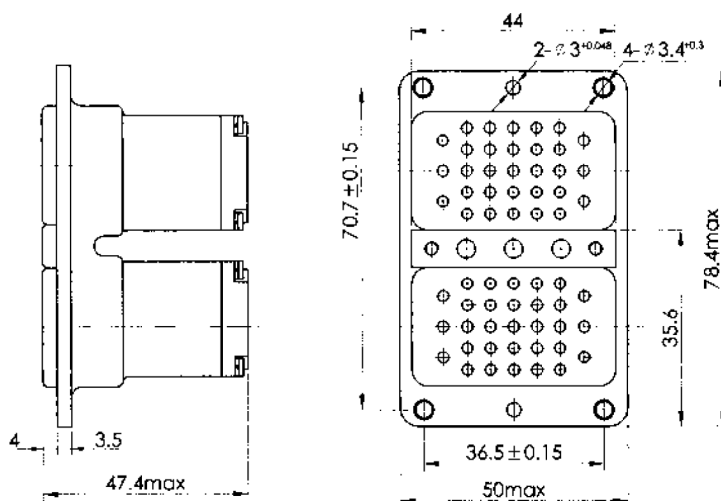

- Socket

